

# BOND UPDATE

May 2023

#ThankYouVoters

The background of the image features several wooden blocks, likely made of light-colored wood like birch or maple, arranged on a dark surface. The blocks are of various sizes and shapes, some with intricate patterns or logos carved into them. One prominent block in the foreground has a logo that appears to be the University of Georgia's 'UGA' logo. Other blocks show wavy lines, concentric circles, and other geometric patterns. The lighting is warm, highlighting the natural grain of the wood.

# **2019 BOND CONSTRUCTION UPDATE**

- **Waller Junior High Renovations and Additions**
  - Phase **1B** two-story addition is on schedule for August 2023 opening.
- **Schultz Junior High Renovations**
  - Substantially Complete.
  - Electronic display and front entry canopy are planned for June installation.
- **Holleman Elementary Renovations**
  - New emergency generator remains on order for fall 2023 installation.
- **Priority 1 Projects -**
  - ■ Chillers, HVAC, and Generators for Field Store and Technology remain in design review before finalizing plans and bidding.

An architectural rendering of a modern school building, Waller Junior High. The building features a large glass entrance with a flat roof supported by several dark, angled columns. To the left, there's a section with horizontal siding and windows. To the right, large letters 'W J H' are visible on the wall. An American flag flies on the left. People are shown walking around the entrance, and cars are parked in the foreground. The entire image has a reddish-orange tint.

# **WALLER JUNIOR HIGH**

**PHASE 1 COMPLETION SUMMER 2023**  
**PHASE 2 COMPLETION SUMMER 2024**



# WALLER JUNIOR HIGH

---

- MEP trim out in progress throughout the new addition. Ceiling coverup to start.
- CenterPoint Permanent Power installation is pending, and being coordinated.
- Central Plant started utilizing a temporary generator, and chillers operational.
- Final wall paint continues throughout the Phase 1 addition.
- Hallway laminate, classroom linoleum, and gym wood floors have started.
- Installation of interior laminate wood doors 90% complete.
- Kitchen equipment installation is complete. Startup and testing ongoing.
- Exterior metal wall panels are 85% completed.
- Phase 1 sidewalks and paving are 95% completed.
- West Campus abatement and demo on West campus during the of summer 2023.



CAFETERIA COURTYARD

# WALLER JUNIOR HIGH



COURTYARD AREA



# WALLER JUNIOR HIGH



MEDIA CENTER & CAFETERIA CORRIDOR





LGI INSIDE MEDIA CENTER



GLASS STOREFRONT WALLS





# WALLER JUNIOR HIGH



TILE FLOORING AND WAINSCOT

# WALLER JUNIOR HIGH



TILE ACCENT WALL





STAIR RAILING MOCK UP



STUDENT RESTROOM ENTRANCE

# WALLER JUNIOR HIGH



STUDENT RESTROOM PARTITIONS





TOP OF MAIN STAIRS





ACCENT WALL

# WALLER JUNIOR HIGH



COLLABORATION AREA



# WALLER JUNIOR HIGH



ACCENT WALL



COLLABORATION AREA



# WALLER JUNIOR HIGH



CLASSROOM FLOORING INSTALLED

**WALLER ISD**  
**CONSTRUCTION**

# WALLER JUNIOR HIGH



CLASSROOM ACCENT WALL w/ WHITEBOARDS

# WALLER JUNIOR HIGH



CLASSROOM ACCENT WALL w/ WHITEBOARDS

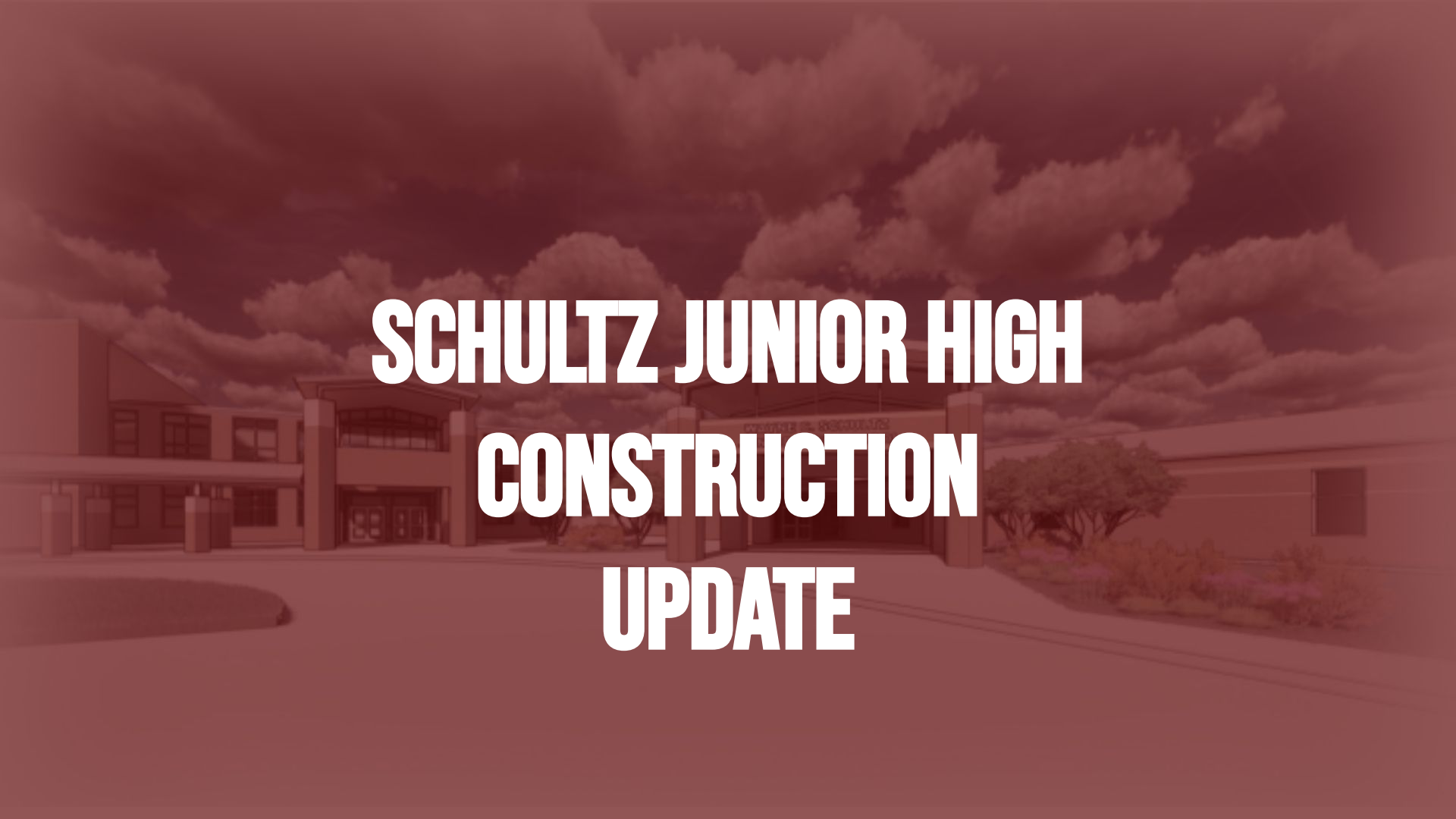

The background image is a photograph of a school building, identified by the text as Schultz Junior High. The building is a two-story structure with a central entrance featuring a portico supported by columns. There are several windows and a sign above the entrance that is partially visible. The sky is filled with large, white, fluffy clouds. The entire image is overlaid with a semi-transparent reddish-brown filter. The text "SCHULTZ JUNIOR HIGH CONSTRUCTION UPDATE" is centered in the image in a large, bold, white, sans-serif font.

# **SCHULTZ JUNIOR HIGH CONSTRUCTION UPDATE**

- New Entry Canopy and Electronic LED Marquee have been ordered for summer 2023 installation.
- •Additional renovation scope included in the 2022 bond Priority 1 Improvement package for summer 2023.

# HOLLEMAN ELEMENTARY

A photograph of a modern elementary school classroom. The room features a curved ceiling with several circular recessed light fixtures. The walls are a light, neutral color. In the center of the room, there is a large blue rug with a colorful geometric pattern. Surrounding the rug are several pieces of furniture, including a large curved sofa in the foreground, a wooden rocking chair, and several smaller armchairs in shades of blue, orange, and grey. In the background, there is a large blackboard or whiteboard on a stand. The overall atmosphere is bright and contemporary.



- New Emergency Generator is ordered and awaiting delivery in October 2023.
- Additional renovation scope being reviewed for 2022 Bond Priority 1 work package in summer 2024.

A photograph of a classroom scene with a teacher and several young students. The teacher, a woman with long brown hair wearing a pink dress, stands in the center background behind a wooden table, holding a book. She is addressing a group of about ten children who are sitting on a grey carpeted floor in a semi-circle. The children are of various ethnicities and are looking towards the teacher. The classroom has large windows on the left, bookshelves filled with books, and a clock on the wall. A green pillar with a Dr. Seuss illustration is on the right. The entire image has a reddish-pink tint.

# **2019 PRIORITY ONE CONSTRUCTION UPDATE**

# PRIORITY 1 PROJECTS

- **FIELD STORE ES**
  - Fire Pump Generator and Replace both Chillers.
  - Design and constructability follow up reviews being scheduled with CMA.
  
- **TECHNOLOGY FACILITY**
  - Emergency Generator and HVAC Upgrades.
  - Design and constructability follow up reviews being scheduled with CMA.



An architectural rendering of a modern school building with a long, low profile and a corrugated metal roof. A large American flag flies on a tall pole in front of the building. Several people are depicted walking on the sidewalk and in the parking lot. A blue car is parked in the foreground, and a white pickup truck and a red car are parked further back. The scene is set against a clear sky with some clouds. The entire image has a semi-transparent dark purple overlay.

# **2022 BOND CONSTRUCTION UPDATE**

- **Elementary #6 & #7**
  - Site work has commenced at both sites.
  - Utility agreements are being coordinated with local MUDs and CenterPoint.
- **Agricultural Science Center and Education Service Center (ESC)**
  - Initial design development has started.
  - Construction Manager contract will be awarded in May.
  - Construction scheduled to start in Q4 of 2023.
- **Turlington Elementary Priority 1 - Driveway Improvements**
  - Contract will be awarded in May 2023.
  - Construction scheduled for August 4th completion.
- **Schultz Junior High School Priority 1 - Improvements**
  - Contract will be awarded in May 2023.
  - Construction scheduled during the summer 2023.

# ELEMENTARY #6 & #7

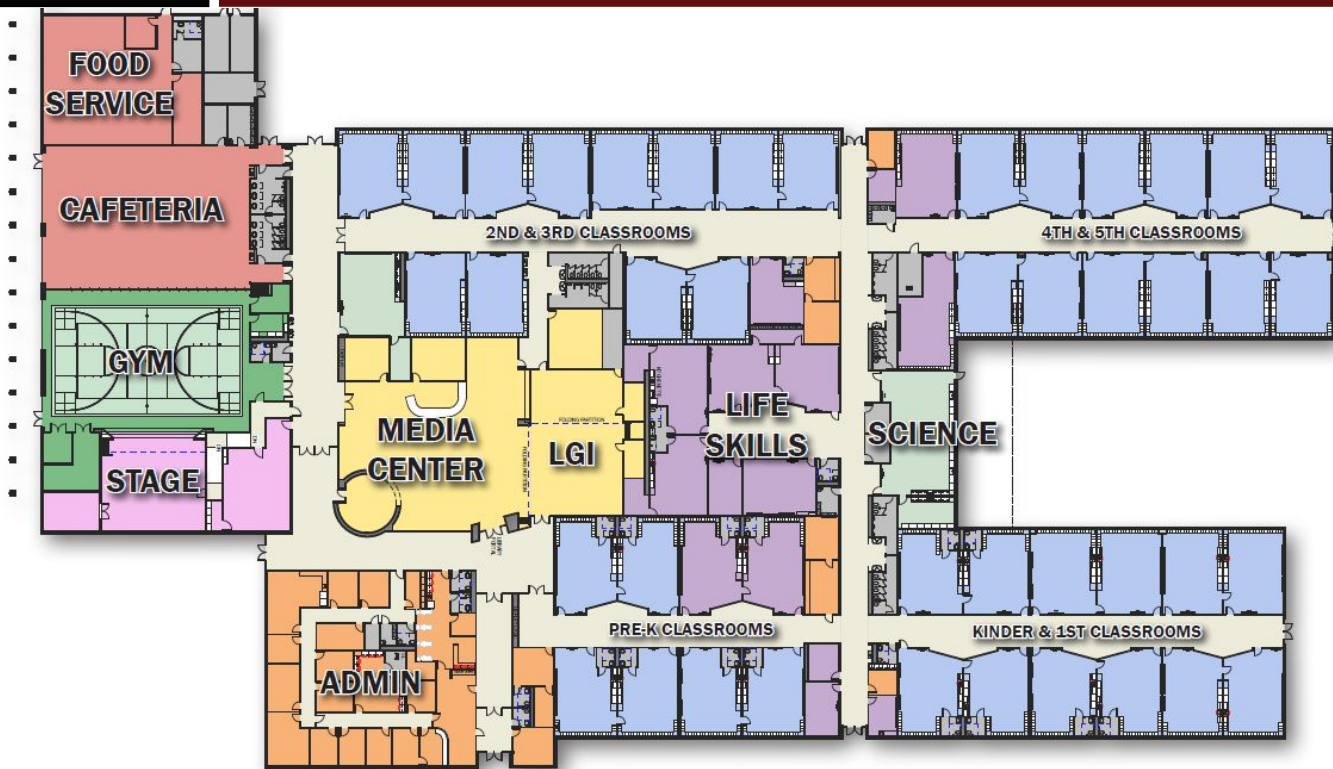



WALLER ISD  
**BOND 22**

# ELEMENTARY #6 - DELLROSE



SCHOOL SITE

**WALLER ISD**  
**CONSTRUCTION**



SCHOOL SITE

**WALLER ISD**  
**CONSTRUCTION**

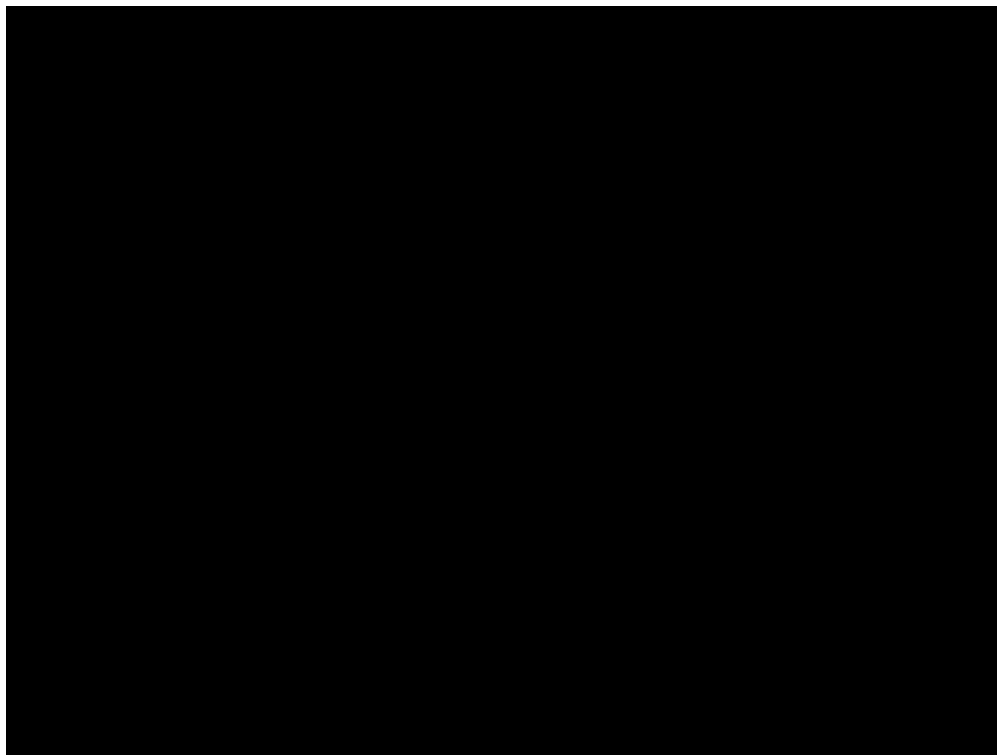

ELEMENTARY ANIMATION



WALLER ISD  
**BOND 22**

# ELEMENTARY #7 - BRIDGELAND



SCHOOL SITE

**WALLER ISD**  
**CONSTRUCTION**



LIBRARY RENDERING





SITE WORK FOR NEW PARENT DRIVE



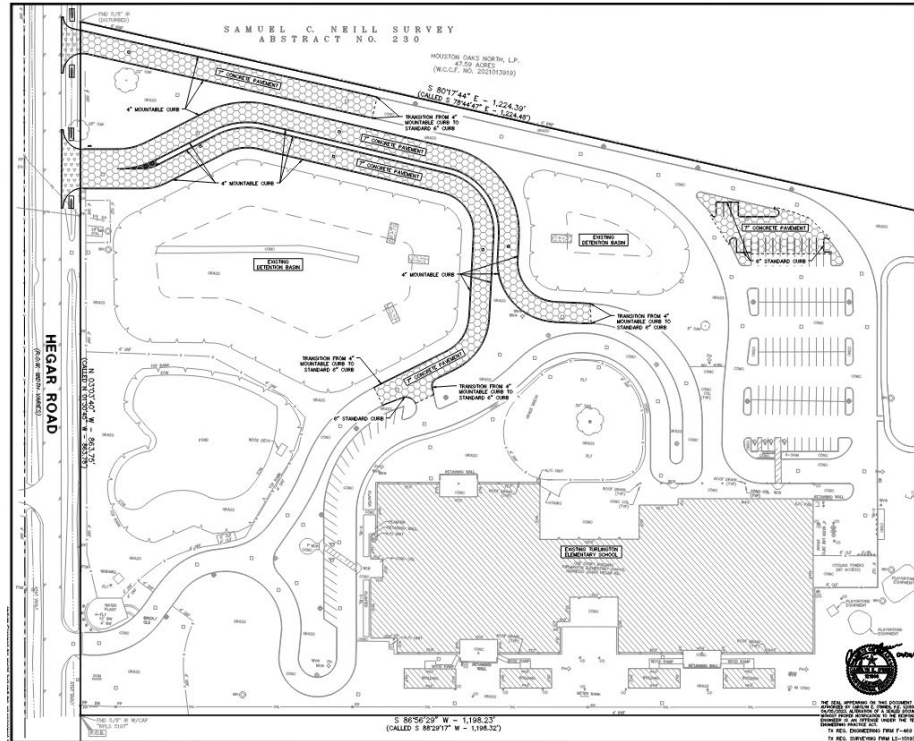

## PLANS FOR NEW PARENT DRIVE

A photograph of a classroom filled with children of various ages, from young children to teenagers. They are all expressing excitement, with many having their arms raised in the air. They are seated at small, light-colored tables with blue chairs. The classroom has white walls, a tiled ceiling, and various educational posters and supplies visible in the background. The entire image is overlaid with a semi-transparent red filter.

# #ThankYouVoters

*Waller*  
Independent School District